

Raccordement à vis:

Longueur de dénudage et embouts

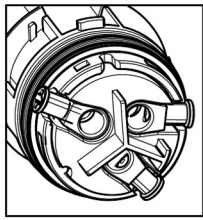

X=

Connecteur:

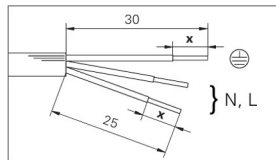

Connecteur, double raccordement

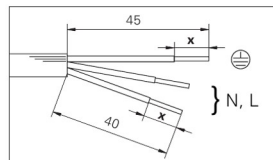

Section de câble	1,5 mm ²	2,5 mm ²	4 mm ²
monobrin	8	8	8
multibrins	8	8	8
multifilaire	8	8	8
rigidifié par soudage ultrason	8	8	8

Raccordement par ressort:



X=

Conducteurs multibrins

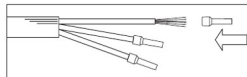

Connecteurs et raccordement d'appareillage

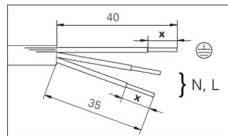

Connecteur, double raccordement

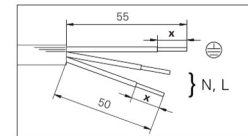

Section de câble	0,5 mm ²	0,75 mm ²	1 mm ²	1,5 mm ²	2,5 mm ²
monobrin	14,5 + 1	14,5 + 1	14,5 + 1	14,5 + 1	14,5 + 1
multibrins	12,0 + 1	13,0 + 1	13,0 + 1	13,0 + 1	
embout selon DIN	46228-E-10	46228-E-12	46228-E-12	46228-E-12	
multifilaire		13,0 + 1	13,0 + 1	13,0 + 1	
embout selon DIN		46228-E-12	46228-E-12	46228-E-12	
rigidifié par soudage ultrason				14,5 + 1	14,5 + 1

Montage

Branchez les conducteurs

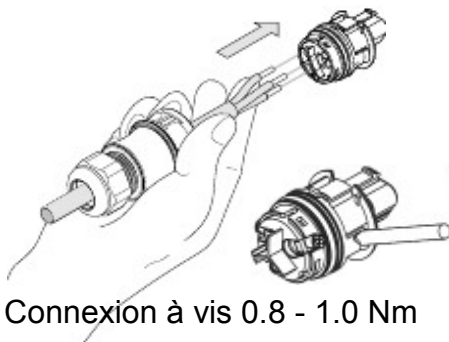

Fermer



Verrouiller

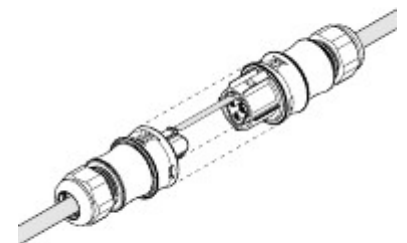

Démontage

Déverrouiller

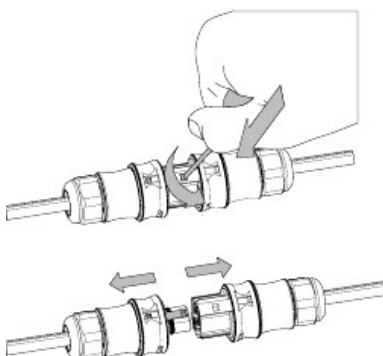

Ouvrir

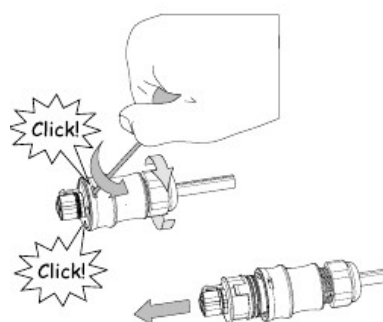

Déconnecter

